



**DESTROYER SERIES**

**TRUCK**

WINCH PLATE



**\*VERIFY YOU HAVE ALL THE COMPONENTS BEFORE STARTING THE INSTALLATION. REFER TO THE ENGINEERING DRAWINGS AT THE END OF THIS DOCUMENT FOR A COMPLETE PARTS LIST\***

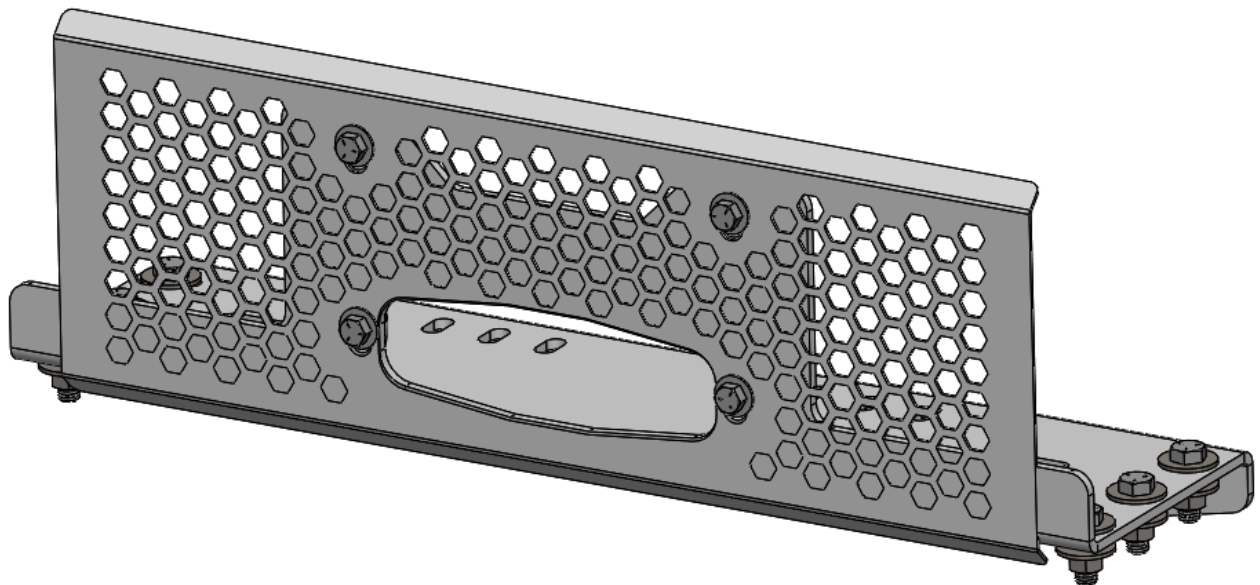

Begin by following the instructions for mounting your the Frame Mounts that are specific for your truck. The Frame Mounts and mounting hardware are included with your bumper.

Leave the Frame Mounts a little loose while you fit the Winch Plate into position.



Frame Mounts

Place the Winch Plate onto the Frame Mounts as shown. Loosely install the six  $\varnothing 1/2"$  bolts as shown.

Your truck may have an intercooler and a plastic or rubber shroud like the one shown here. If so you might need to trim the shroud around the Winch Plate. Trim the shroud before continuing with the installation.



Trim Shroud here if needed

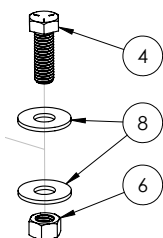

Place your winch onto the Winch Plate and position as needed. If you cannot fit the winch into place, you may have to install the winch onto the Winch Plate before you install the Winch Plate onto the Frame Mounts.

Finish installing your winch. Be sure your winch mounting bolts are tight and run your cables as necessary.



For base mounted winches, your Winch Plate has 3 possible mounting locations. Choose the position which centers your winch spool with the fairlead opening.

Base Mount Hole Locations

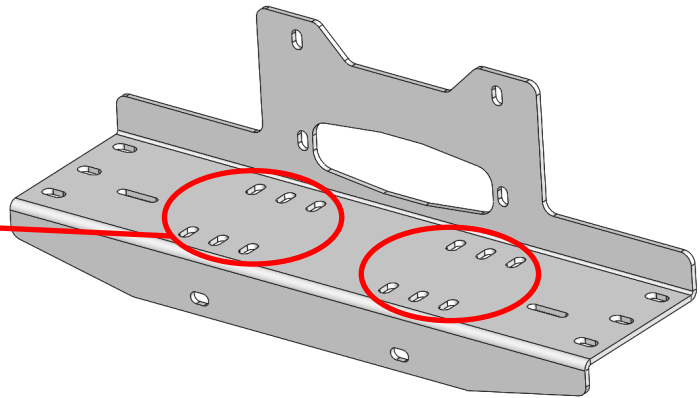

For face mounted winches, there is only one position for mounting. When face mounting a winch on your LOD Winch Plate, you must use the additional base screw mount location on your winch.

Face Mount Hole Locations

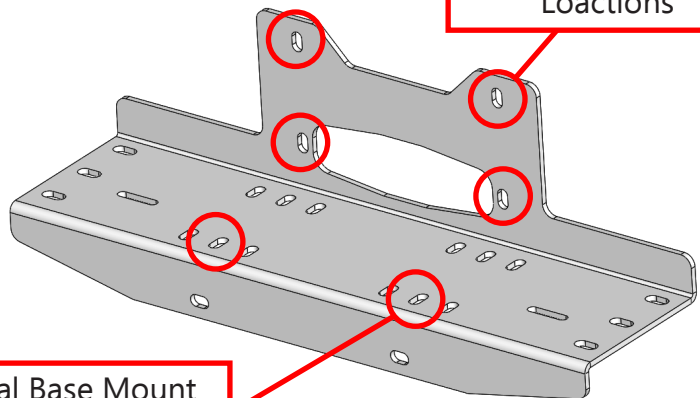

Additional Base Mount Hole Locations

**\*\*DO NOT MOUNT YOUR WINCH USING ONLY THE 4 FACE MOUNT LOCATIONS!\*\***

Adjust the Frame Mounts so that the Winch Plate sits relatively level. Then position the winch and Winch Plate so that they are centered within the Frame Mounts.

Snug the bolts for the Frame Mounts first, then securely tighten all six Winch Plate Mounting bolts. You will tighten the Frame Mount bolts later on in the bumper installation



Depending on how your fully assembled bumper fits on your truck, you may need to loosen the Frame Mounts to allow the bumper to pivot or shift up or down.



Install the Winch Front Screen by sandwiching it between your fairlead and the Winch Plate. Mount securely using the Ø7/16" Bolts provided and the double Flag Nut.

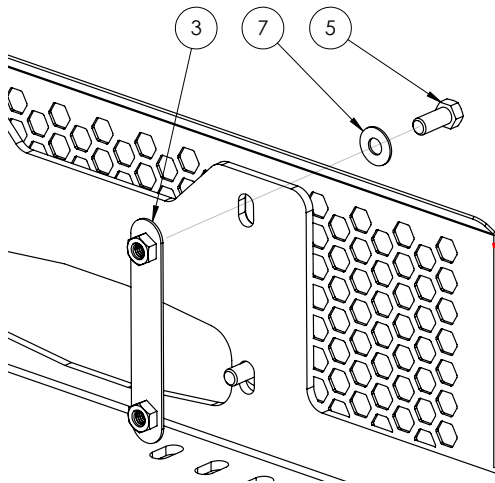

Test fit the Bumper Center. Check to make sure the Winch Plate and Screen are centered within the bumper opening and adjust as necessary.



## **\*\*Maintenance\*\***

- Periodically check and re-tighten all fasteners.
- Periodically check your product for scratches, dings, or rust spots which can happen over time or after heavy use. It is important to address these areas as soon as possible to prevent rust and corrosion from spreading. We recommend using Rustoleum® brand Black Semi-Gloss Protective Enamel (oil based). Apply using a foam brush by dabbing to match the powder coat texture.



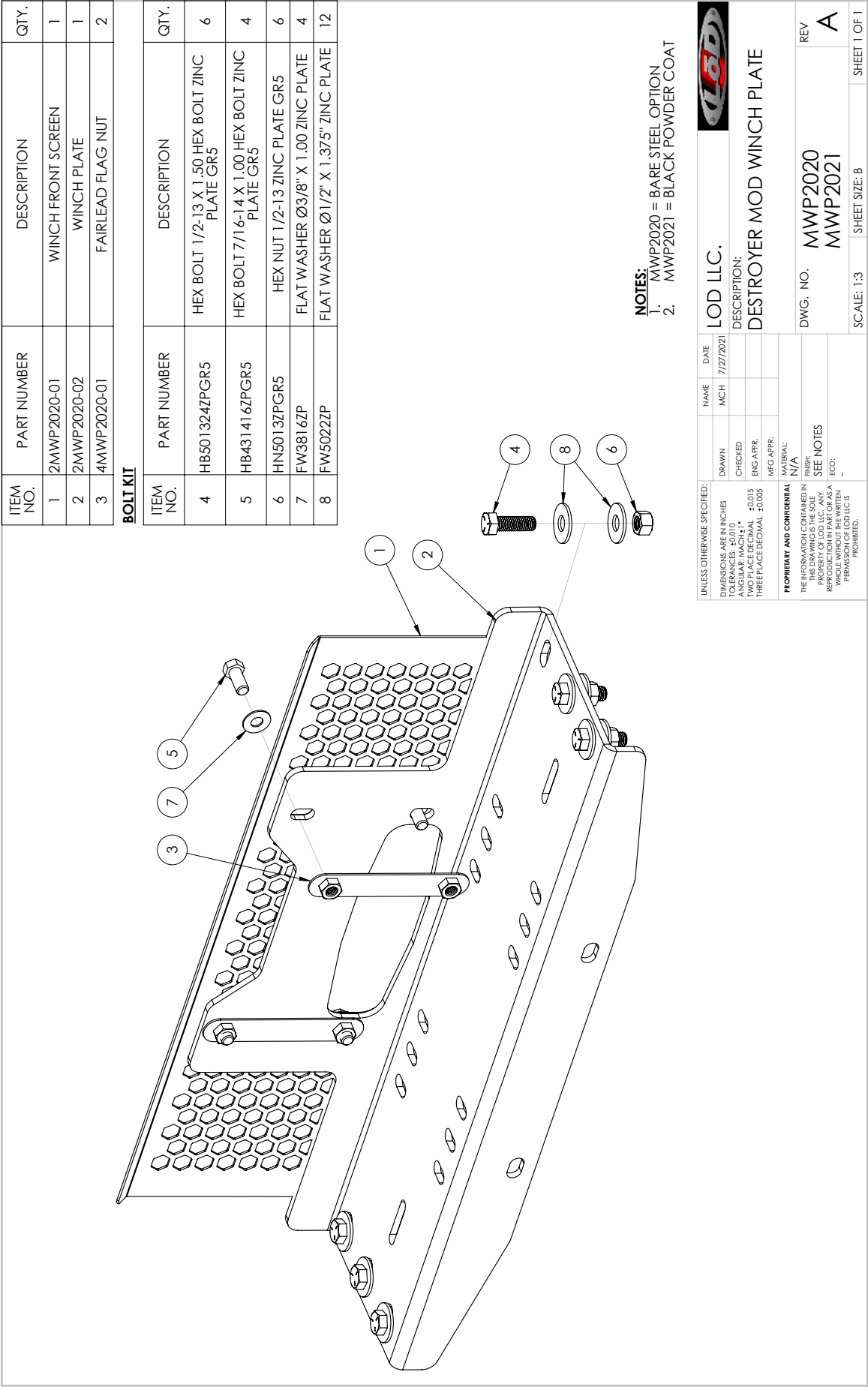



**TRUCK  
DESTROYER SERIES**  
WINCH PLATE  
SHIPPING SHEET

Packaged by:

\_\_\_\_\_

On:

\_\_\_\_\_



INSTRUCTION  
SHEET

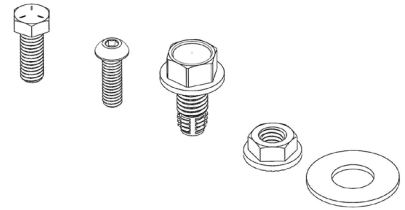

BOLT KIT  
(may vary)



WINCH PLATE  
2MWP2020-02  
(x1)

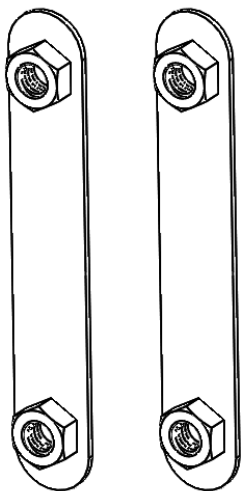
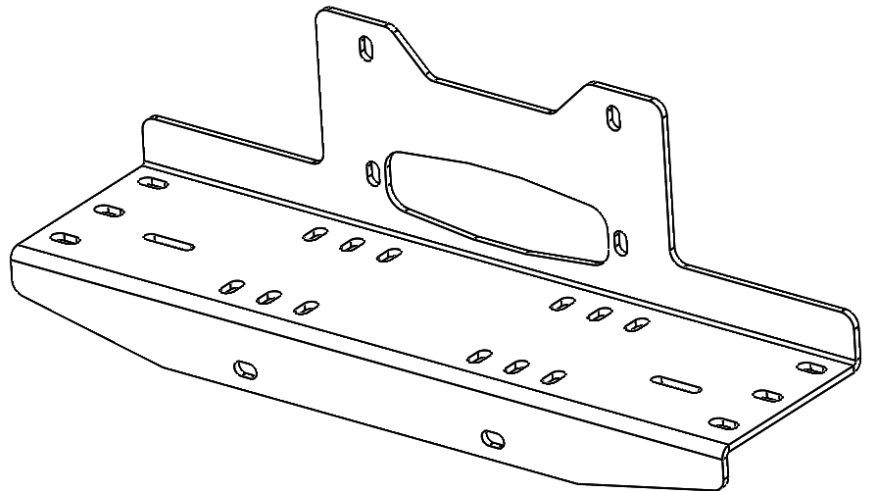

FAIRLEAD FLAG NUT  
4MWP2020-01  
(x2)

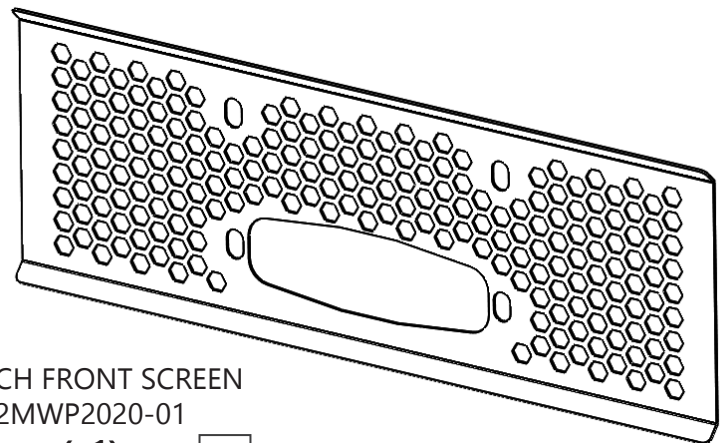

WINCH FRONT SCREEN  
2MWP2020-01  
(x1)





**TRUCK  
DESTROYER SERIES**  
WINCH PLATE

Bolt Kit

Packaged by:

\_\_\_\_\_

On:

\_\_\_\_\_

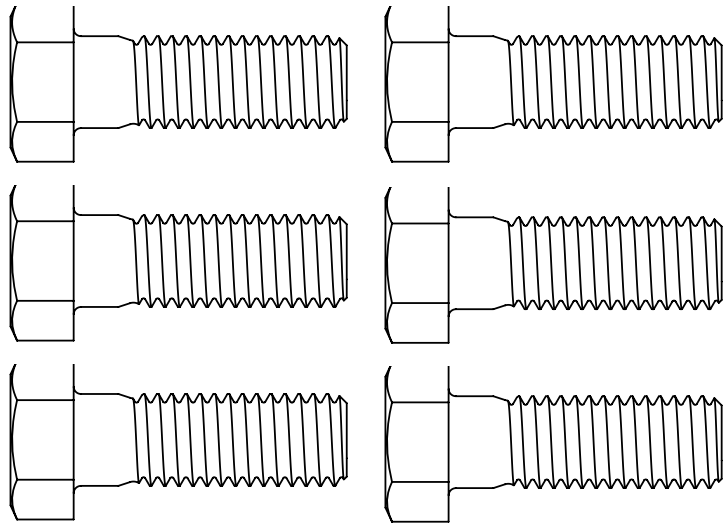

HEX BOLT 1/2-13 X 1.50"  
(0137545)

**(x6)**

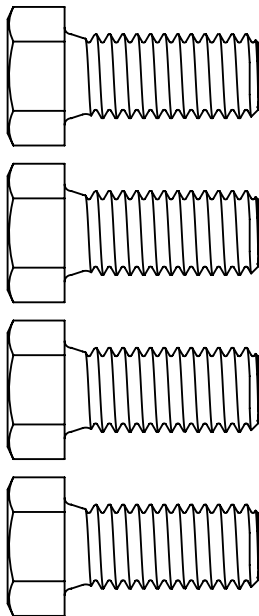

HEX BOLT 7/16-14 X 1.00"  
(0137531)

**(x4)**

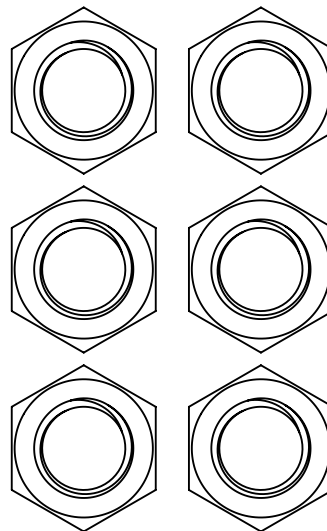

HEX NUT 1/2-13  
(0147968)

**(x6)**



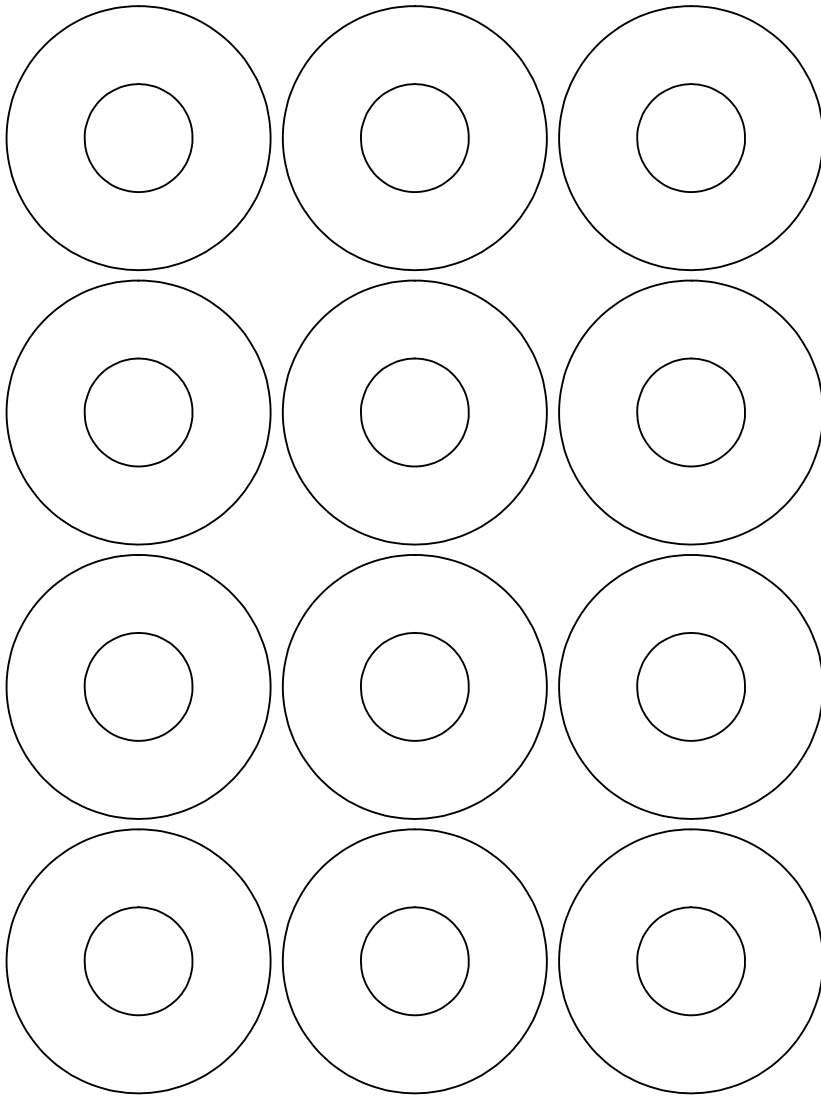

FLAT WASHER  
Ø1/2" X 1.375"  
(0159681)  
**(x12)**

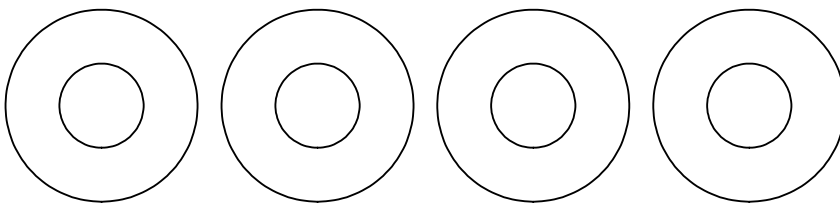

FLAT WASHER  
Ø3/8" X 1.00"  
(0159723)  
**(x4)**

